



PRO STEEL REGULATION HOCKEY NET
BUT DE HOCKEY PROFESSIONNEL REGLEMENTAIRE EN ACIER

72 in. / 1,82 m

Assembly Instructions | Instructions d'assemblage

1

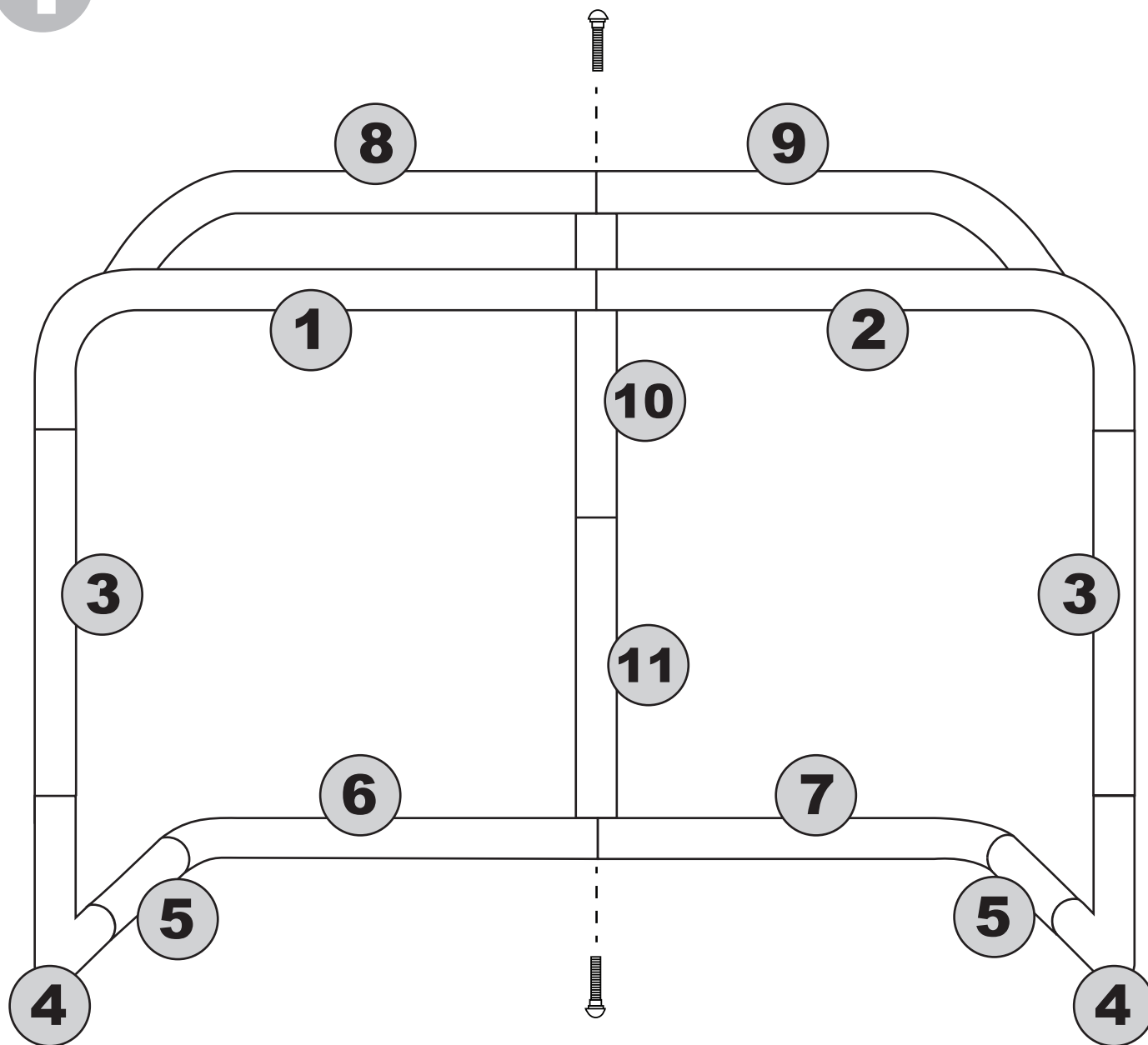

2

Position the mesh by lining the red tabs to the two top corners and secure with the "zip ties" provided.
Placer le filet en alignant les languettes rouges avec les deux coins supérieurs et faire tenir à l'aide des attaches fournies.

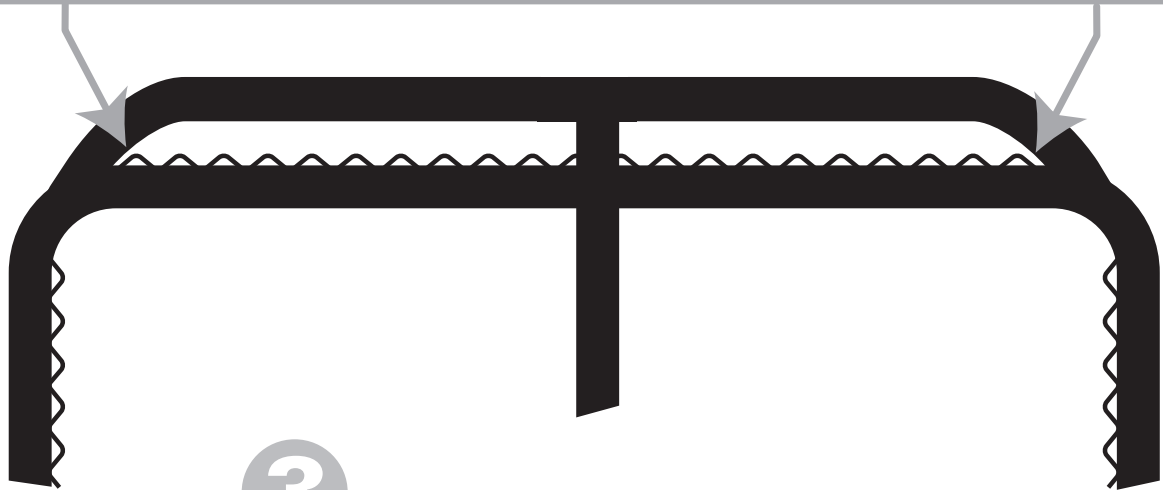
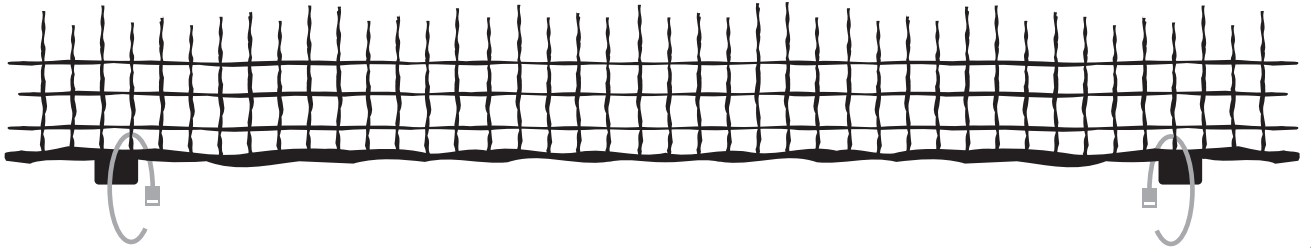

3

