

SHOOTING TARP HEAVY DUTY

MODEL#
TG84ST55

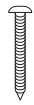

A x4



B x9



C x9

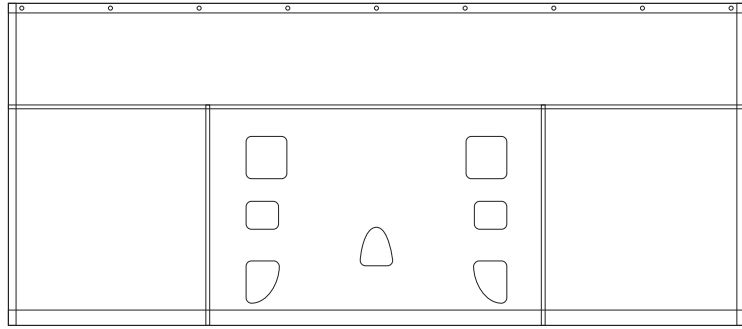

D x1

PREPARATION

1. Lay tarp flat on ground
2. Position bungees behind the **2nd, 4th, 6th and 8th** grommets [Bungee's are used to roll tarp up when not in use]

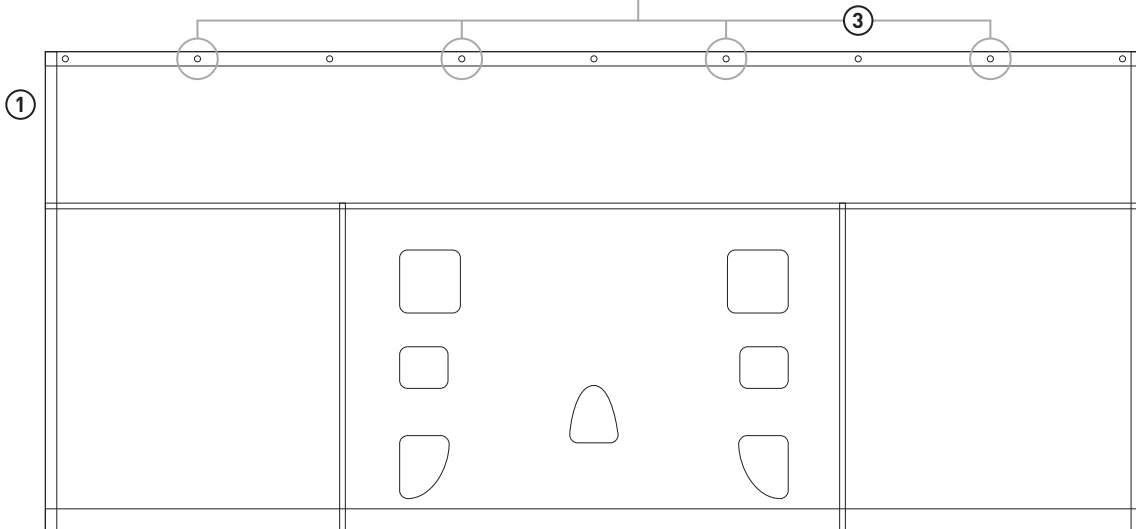
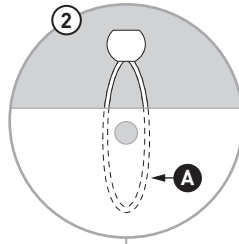

SHOOTING TARP HEAVY DUTY

MODEL#
TG84ST55

INSTALL TARP ABOVE GARAGE DOOR

3. Align tarp to the top of trim board/frame over the garage door
4. Attach tarp using the 9 metal grommets and standard screws and washers
5. Insert 16' wooden closet dowel (not included) into the bottom sleeve of the tarp
- 6*. If installing in front of a wall there should be a 12" buffer zone to avoid damage to the wall

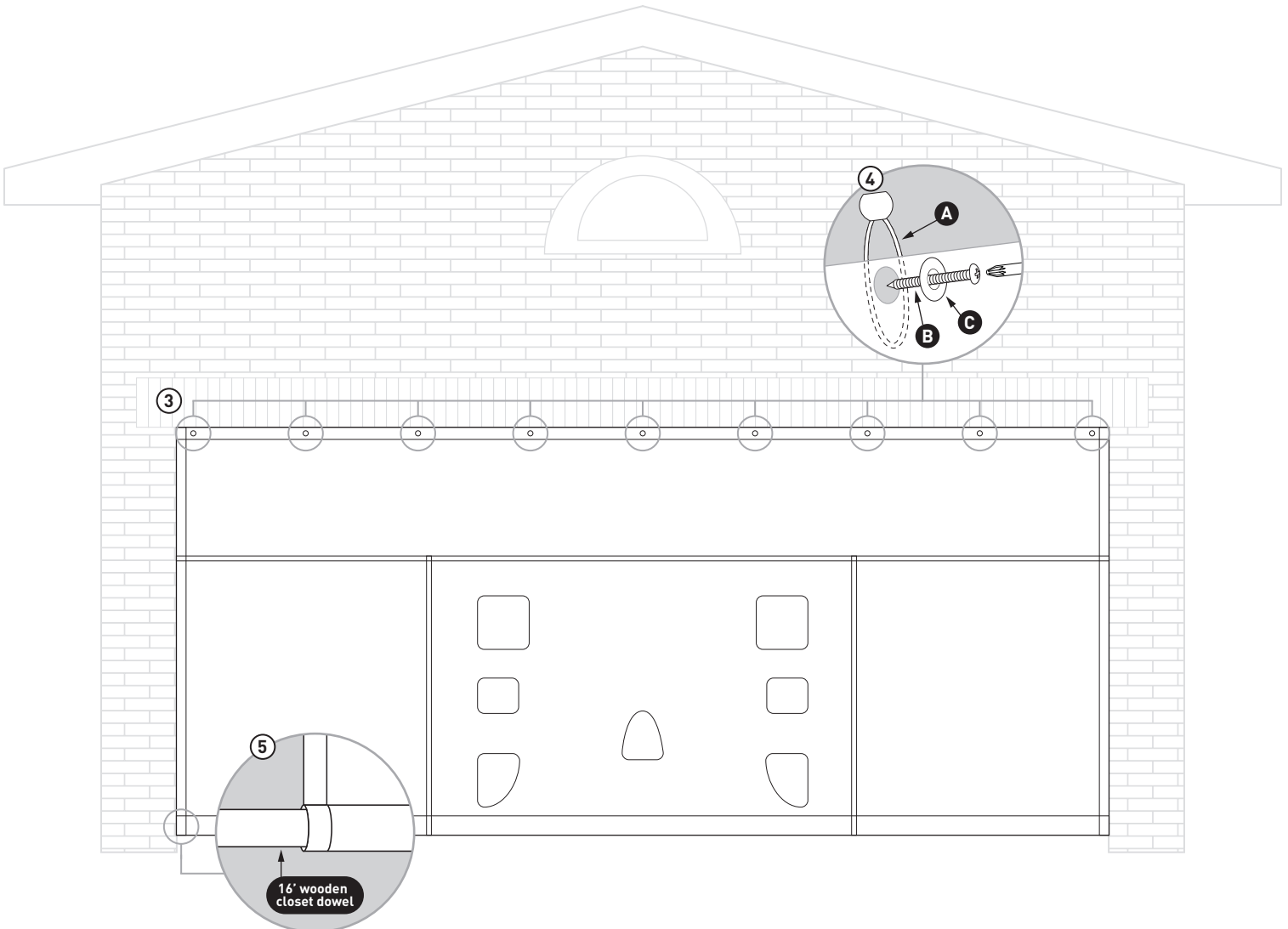
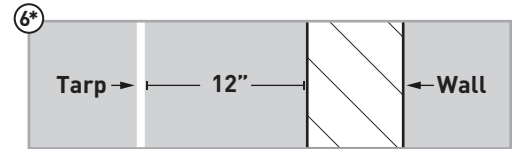

SHOOTING TARP HEAVY DUTY

MODEL#
TG84ST55

OPTION: HANGING INSTALL IN GARAGE/BUILDING/BASEMENT/WAREHOUSE

1. Attach tarp using the 9 metal grommets to a standard 2x4 (not included)
2. Keep the bungee ball cords between the tarp and the 2x4
3. Attach three hook screws (not included) to the 2x4 and hang from the ceiling using rope, cable or chain (not included)

